

FILED 2002-2747

RECORDER'S OFFICE

CHICKASAW COUNTY, IOWA

JUL #600
2002 NOV 13 AM 8 34GINDY MESSERSMITH
COUNTY RECORDER

Prepared by: Erdman Engineering, P.C. 708 Commerce Drive, P.O. Box 246 Decorah, Iowa 52101, (563)382-4194

United States Public Land Survey Corner Certificate
ofLand Survey Monuments situated in Section 8, Township 96, Range 11 West of
the 5th Principal Meridian in Chickasaw County, Iowa. Previously recorded in
does not apply in the county Recorder's Office.

Monument Description and Remarks: This certificate is prepared in accordance with Section 193C of the Code of Iowa. No previous certificate has been filed for this corner location. Based on Chickasaw County Engineer's Reference Ties, we searched for the tie markers previously set. We did not find any. We searched for the iron pin previously set. We found 3/4" diameter steel bar with yellow plastic cap, (number not legible) down $\pm 2"$ below the crushed rock surface at approximate centerline of the county road. We used the monument as the S $\frac{1}{4}$ Corner of Section 8, Township 96 North, Range 11 West.

Plan-View

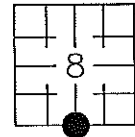
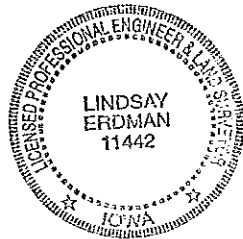
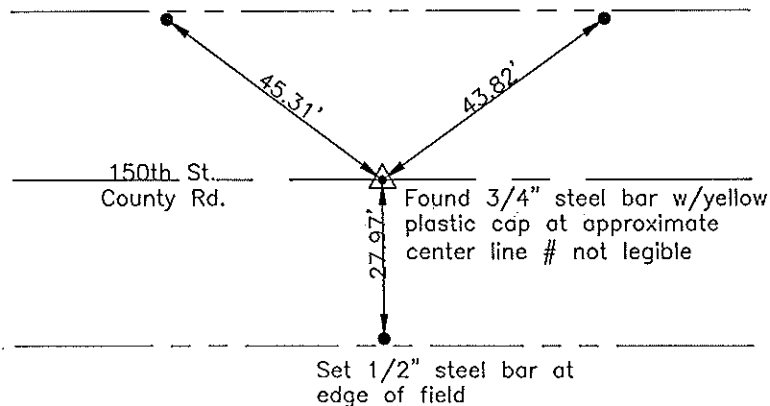
Set 1/2" steel bar at
edge of fieldSet 1/2" steel bar at
edge of field

Cor A

I hereby certify that the survey work was completed and this certificate was prepared by me or under my direct supervision and that I am a duly registered land surveyor under the laws of the State of Iowa.

Signature

Lindsay Erdman, P.E. and L.S.

Date: 11/5/02 Reg. No. 11442

My license renewal date is December 31, 2002

Corner(s) to be Indexed

Corner	Section	Township	Range
S 1/4	8	96	11

Filed 11-18-02