

Prepared by: Erdman Engineering, P.C., 708 Commerce Drive, P.O. Box 246, Decorah, Iowa, (563)382-4194

UNITED STATES PUBLIC LAND SURVEY CORNER CERTIFICATE
 OF

Land Survey Monuments situated in Section 36, Township 97 North, Range 14 West, of the Fifth Principal Meridian, Chickasaw County, Iowa, Previously recorded in does not apply in the County Recorder's Office.

Monument Description and Remarks:

This certificate is prepared in accordance with Section 355.11 of the Code of Iowa. No previous certificates have been filed for these corner locations.

Center Section: We found no record of the Center of Section 36 being set. We found no evidence of a monument in the field other than the county road and a fence line running west. We set a 1/2" diameter steel bar with 1 1/2" aluminum cap #11442 in line with the fence line running west and at the center of the 66' wide county road right-of-way, as the Center of Section 36, Township 97 North, Range 14 West.

S 1/8 Corner: We found no record of the S 1/8 Corner being set. We found no evidence of a monument in the field other than the county road. We found the S 1/4 Corner and set the Center of Section 36. We set a 1/2" diameter steel bar with 1 1/2" aluminum cap #11442 on line and midway between the Center Section and the S 1/4 Corner, at the approximate centerline of the 66' wide county road right-of-way, as the S 1/8 Corner of Section 36, Township 97 North, Range 14 West.

PLAN-VIEW
 (NOT TO SCALE)

Center Section

Set 1/2" diameter steel bar with 1 1/2" aluminum cap #11442

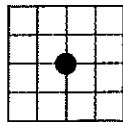

SECTION 36

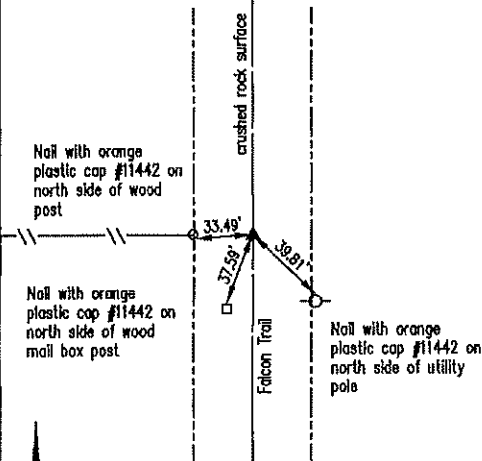

Cor O-36-97-14

S 1/8 CORNER

Set 1/2" diameter steel bar with 1 1/2" aluminum cap #11442

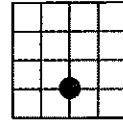

SECTION 36

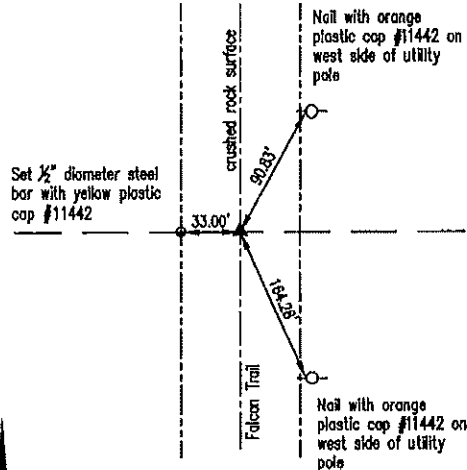

Cor J-36-97-14

I hereby certify that this land surveying document was prepared and the related survey work was performed by me or under my direct personal supervision and that I am a duly licensed Land Surveyor under the laws of the State of Iowa.



Lindsay Erdman 10/16/20
 Date

Lindsay Erdman, P.R. & P.L.S.
 Licensed Professional Land Surveyor
 Iowa License Number 11442
 My License renewal date is December 31, 2020
 Pages or sheets covered by this seal: THIS SHEET ONLY

List Corner(s) to be Indexed

Corner(s)	Section	Township	Range
C.S.	36	97N	14W
S 1/8	36	97N	14W

ERDMAN
ENGINEERING, P.C.
 CIVIL ENGINEERING & LAND SURVEYING
 Decorah, Iowa